

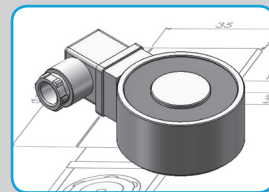

**ELECTROMAGNET**  
Plug Type



Item no.

4 1 9 2 1 6 0  
1 2 3 4 5 6 7

Voltage:

230VAC 9

205VDC 8

110VAC 6

Application:

St connector on OD 1

St connector back side 4

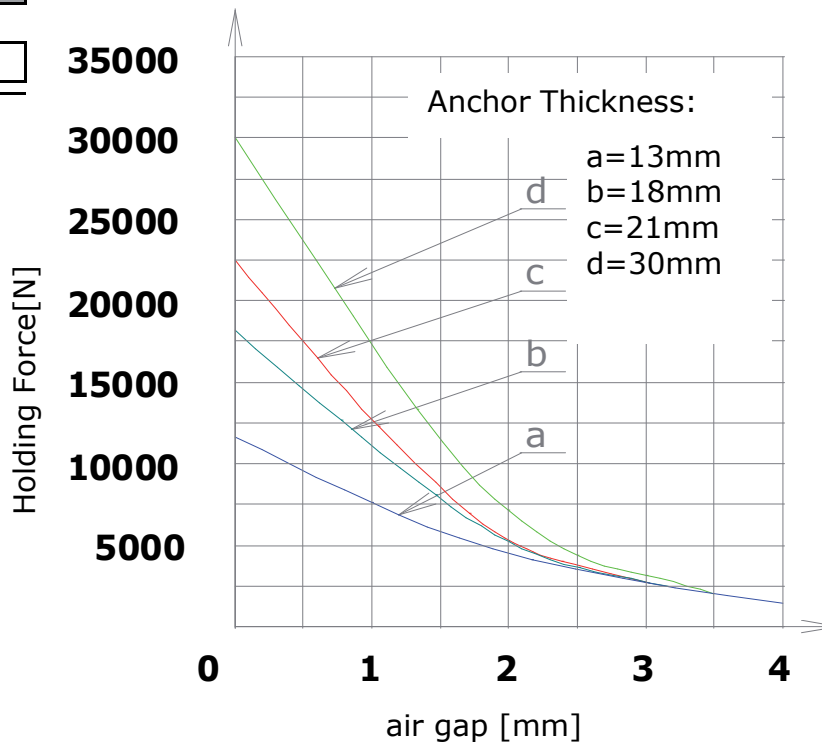

Specific Values	
Duty Cycles [sec]	∞ [100%ED]
Power [W]	90
Holding Force [N]	30000
Anchor Thick. [mm]	30
Weight [KG]	25,9
Sizes [mm]	
A	Ø250
B	80
C	117,5
D	223
E	M24
F	36
G	16
H	153
I	300
J	27,5
K	3
L	90
M	M8

