

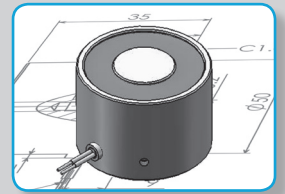

PERMANENT ELECTRO MAGNET

Cable



Item no.

4	2	4	0	0	2	3
1	2	3	4	5	6	7

Voltage:

24VDC 4

6 VDC 2

12VDC 3

48VDC 5

Application:

St zn cable 0

St zn connector 1

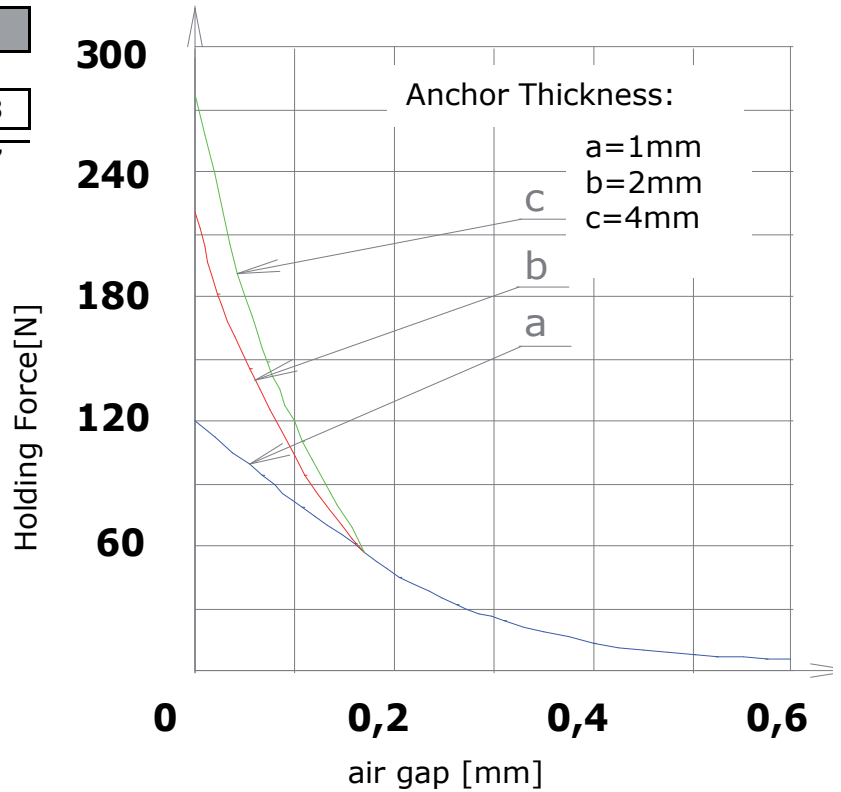

Data	Specific Values	
	Duty Cycles [sec]	10%ED
	Power [W]	28
	Holding Force [N]	300
	Anchor Thick. [mm]	4
	Weight [KG]	0,2
	Sizes [mm]	
	A	35
	B	29
	C	200
D	M5	
E	19	
F	9	

