

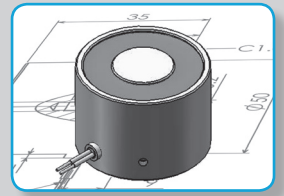

# PERMANENT ELECTRO MAGNET

Cable



Item no.

|   |   |   |   |   |   |   |
|---|---|---|---|---|---|---|
| 4 | 2 | 4 | 0 | 0 | 2 | 5 |
| 1 | 2 | 3 | 4 | 5 | 6 | 7 |

Voltage:

24VDC

6 VDC

12VDC

48VDC

Application:

St zn cable

St zn connector

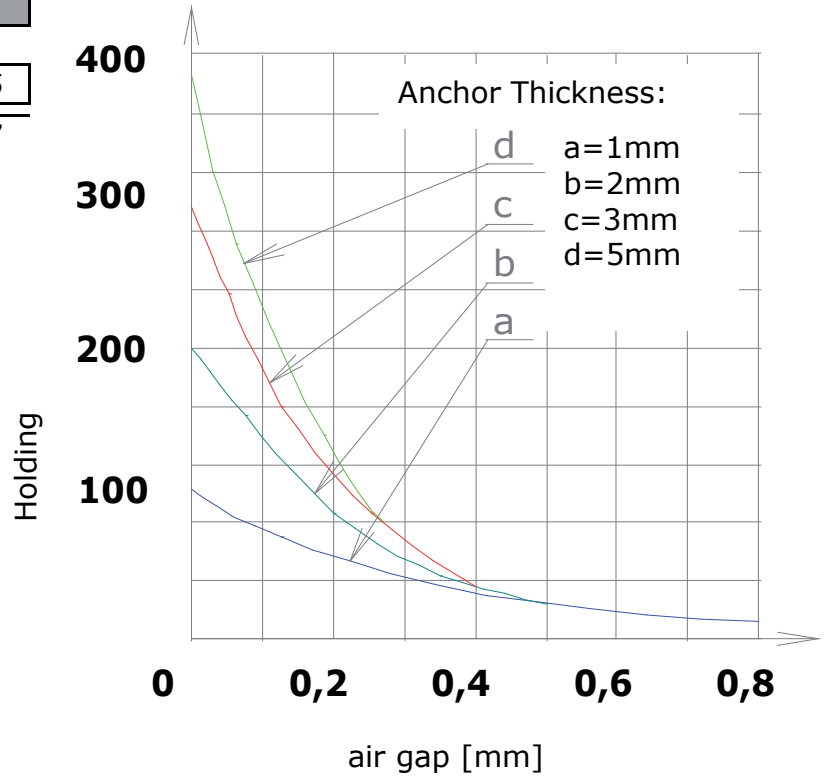

| Data | Specific Values    |       |
|------|--------------------|-------|
|      | Duty Cycles [sec]  | 10%ED |
|      | Power [W]          | 36    |
|      | Holding Force [N]  | 400   |
|      | Anchor Thick. [mm] | 5     |
|      | Weight [KG]        | 0,32  |
|      | Sizes [mm]         |       |
|      | A                  | 40    |
|      | B                  | 29    |
|      | C                  | 200   |
| D    | M5                 |       |
| E    | 15                 |       |
| F    | 9                  |       |

