

Item No.						
3	5		1		4	4
1	2	3	4	5	6	7
Voltage:						
6 VDC		2				
12 VDC		3				
24 VDC		4				
48 VDC		5				
Application:						
one side plunger				2		
double side plunger					6	

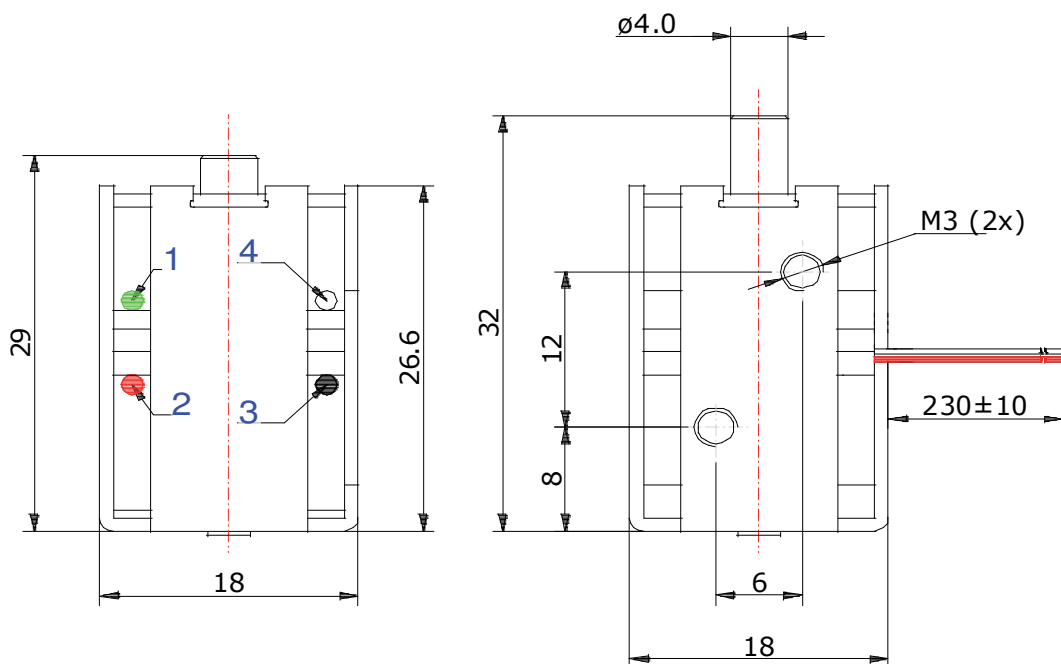
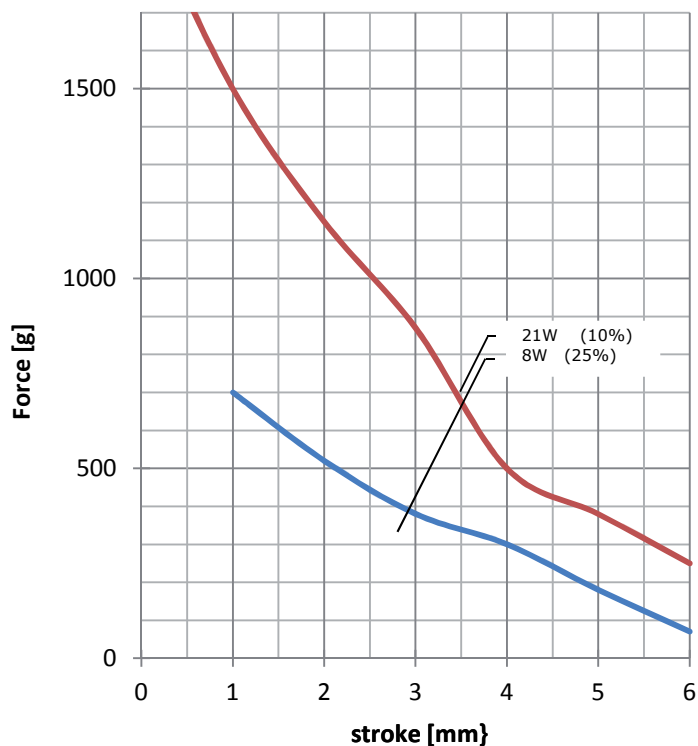

Data	Voltage [V]	Resistance [ $\Omega$ ]	Power [W]	Permanent "0" [g]
	6	1,7	21	800
	12	18	8	800
	24	7	82	800